

# Main Floor

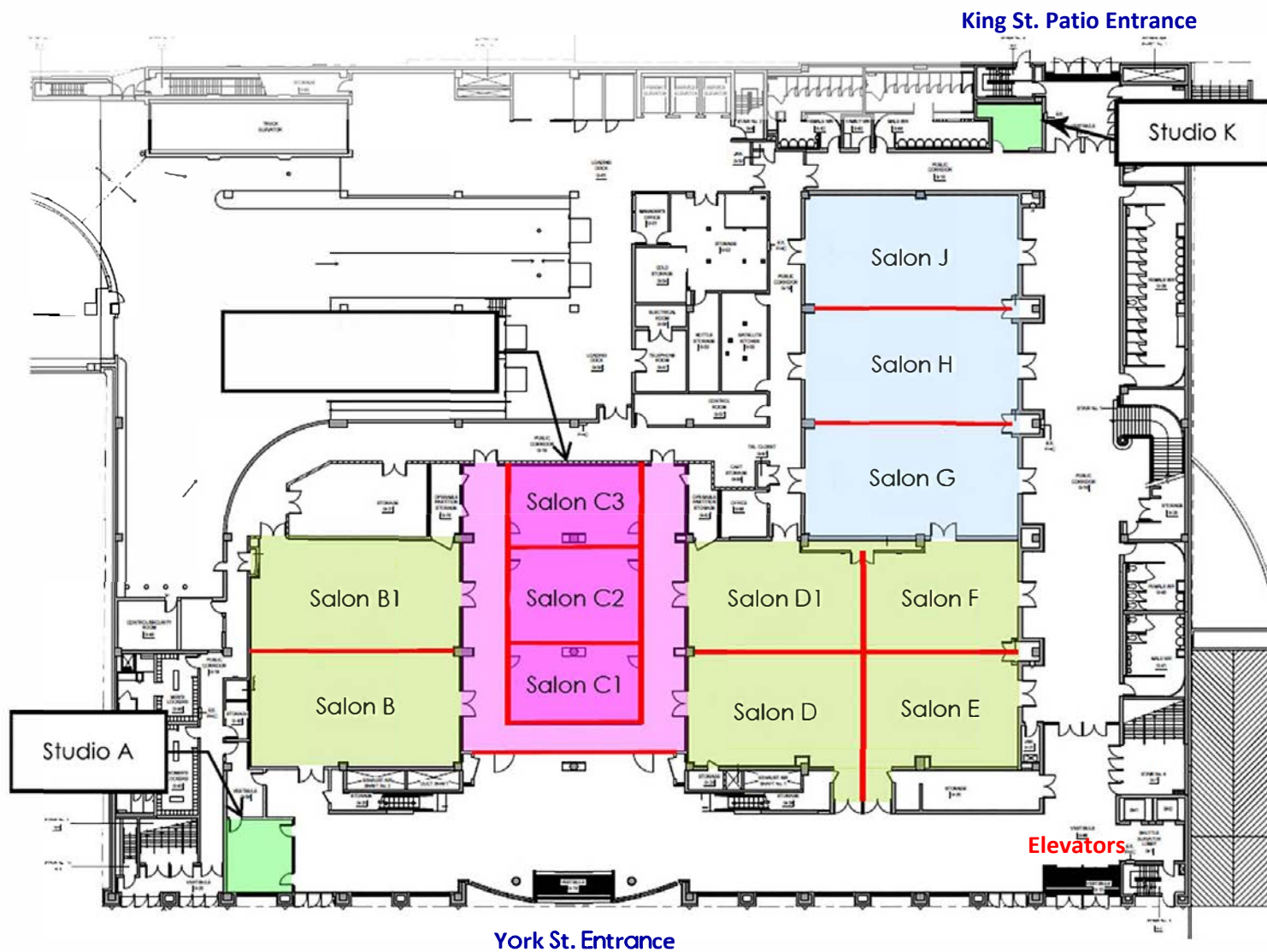

# RBC PLACE LONDON



# MAIN LEVEL Occupancies



# RBC PLACE LONDON

Ceiling Height 12'

## SALONS & STUDIO Room Combinations

	Dimensions (linear feet)	Square Feet	Theatre	Boardroom	Hollow Square	Classroom of 3	Cabaret of 6	Reception	Plated Banquet Rounds of 10	Buffet Banquet Rounds of 10	Tradeshow Booths**
Salon B	29x51	1,479	120	40	42	72	60	120	80	60	-
Salon B1	29x51	1,479	125	40	42	72	54	125	80	60	-
Salon B, B1	58x51	2,958	245	46	72	135	120	245	180	150	13
Salon D	30x44	1,320	110	34	38	54	48	110	60	40	-
Salon D1	29x44	1,276	100	34	42	45	48	100	60	40	-
Salon D, D1	58x44	2,552	210	46	60	96	90	210	120	90	9
Salon E	30x40	1,200	95	28	34	39	36	100	60	40	-
Salon F	29x40	1,160	90	28	34	39	36	90	60	40	-
Salon E, F	58x40	2,320	185	46	60	96	84	190	120	90	8
Salon D, D1, E, F	58x84	4,872	395	70	96	216	204	400	280	200	20
Salon G	54x29	1,566	130	46	54	72	60	130	100	80	10
Salon H	54x29	1,566	130	46	54	72	60	130	100	80	10
Salon J	54x29	1,566	130	46	54	72	60	130	100	80	10
Salon GH or HJ	58x54	3,132	260	46	72	144	150	260	200	160	18
Salon G, H, J	87x54	4,698	390	76	96	210	228	390	280	240	28
Studio A	16x18	288	-	10	-	-	-	-	-	-	-
Salon C1	22x33	726	50	20	-	-	-	-	50	-	-
Salon C2	22x33	726	60	20	-	24	-	-	60	-	-
Salon C3	22x33	726	50	20	-	-	-	-	50	-	-
Salon C1, C2	44x33	1,452	-	20	-	-	-	-	110	60	-
Salon C2, C3	44x33	1,452	-	20	-	-	-	-	110	60	-
Salon C1, C2, C3	66x33	2,178	-	20	-	-	-	160	160	110	-
Studio K	11x12	132	-	6	-	-	-	-	-	-	-
Central Foyer***	74x56	4,144	-	-	-	-	-	340	160	110	22

### Notes

- ▶ Not all room configurations are available simultaneously
- ▶ Please inquire for other set up occupancies not listed above
- ▶ **\*\*Maximum Booth capacity (Combination of 8x10, 10x10)**
- ▶ Room Rental Subject to HST (13%) and Admin Fee (18%)
- ▶ **Occupancies may vary with specific room set up requirements**
- ▶ Banquet capacities based on 66" round tables
- ▶ **\*\*\*Some conditions apply**

Effective July 2022